

LAMP PUMPED LASER HEADS

High performance and reliability

Part No: CHBA767

LASER SYSTEMS: Laser Optronic 767, Evermark 8070, 815, 860

DESCRIPTION: Single-Lamp Pumped Solid-State Laser Chamber used for laser trimming, marking and engraving applications.

LASER HEAD COMPONENTS:

REFERENCE	PART NUMBER	DESCRIPTION
1	WIB767	Water Inlet Block
2	CEP767A	Cavity End Plate, Outlet
3	CH767	Cavity Holder
4	CEP767B	Cavity End Plate, Inlet
5	WOB767	Water Outlet Block
6	CPP767	Crystal Pressure Plate
7	LPP767	Lamp Pressure Plate
8	GCE700	Gold Reflector Tube
9	LL767	Krypton Arc Lamp, 3.5 kW
10	YR485	YAG Rod, 4 mm Rod, Unmounted
11	YRA767	YAG Rod Assembly, 4 mm, Mounted
12	LFT747	Lamp & Rod Flow Tubes
13	ORK767	O-Rings (Included in Kit)
14	WOBSSF767	Stainless Steel Micro Filter

ASSEMBLIES:

REFERENCE	PART NUMBER	DESCRIPTION
1	ORK767	O-Ring Kit
2	HBA767	Head Block Assembly (Less YAG Rod & Lamp)
3	CHBA767	Complete Head Block Assembly

LAMP PUMPED LASER HEADS

High performance and reliability

Part No: CHBA767

FREQUENTLY USED CONSUMABLES:

REFERENCE	ITEM	PART NUMBER
1	Lamp	LL767
2	Lamp & Rod Flow Tube	LFT767
3	Front Mirror 90% R	MRIM90RHC
4	Rear Mirror HR	MRIMI00RHC
5	D.I. Cartridge	D2002
6	Particle Filter, 10"	PF10

Other consumables upon request.

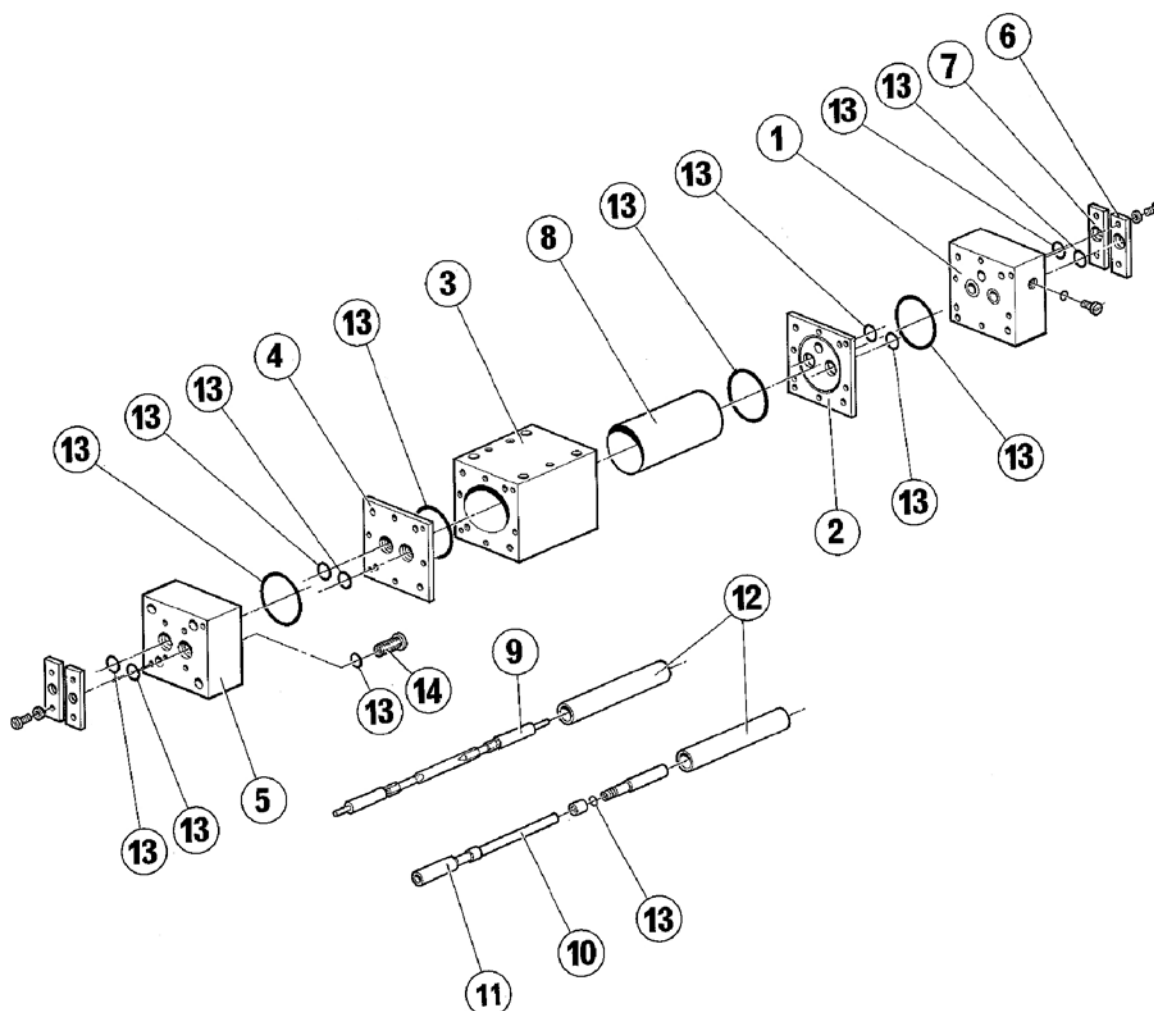

Intelligent Solutions, Manufacturing & Development