

LAMP PUMPED LASER HEADS

High performance and reliability

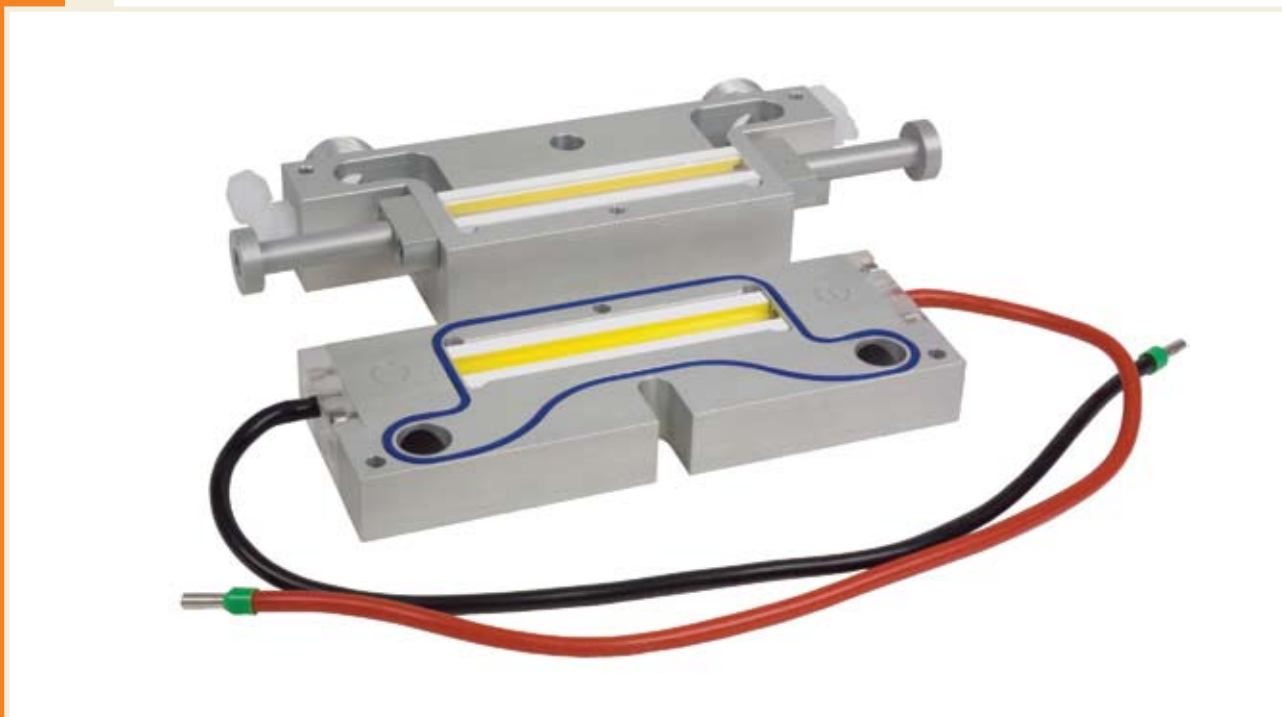

Part No: CHBAFOBA100

LASER SYSTEMS: Foba 90MK-DT, 94S, 100 Watt, Alltec LNI00W

DESCRIPTION: Single-Lamp Pumped Solid-State Laser Chamber used for precision marking and deep engraving applications.

ASSEMBLIES:

Reference	Part Number	Description
1	ORKFOBA100	O-Ring Kit, FOBA # M49000
2	LHBACFOBA100	Lower Head Block Complete, Includes YAG Rod
3	UHBACFOBA100	Upper Head Block Complete, Includes YAG Rod
4	HBAFOBA100	Head Block Assembly Less Rod & Lamp
5	CHBAFOBA100	Complete Head Block Assembly

Part No: CHBAFOBA100

LASER HEAD COMPONENTS:

REFERENCE	PART NUMBER	DESCRIPTION
1	LPPFOBA100	Lamp Pressure Plate (FOBA # M33050)
2	UHBFOBA100	Upper Head Block (FOBA # M31050)
3	CCEFOBA100U	Ceramic Cavity, Upper (FOBA # 034120)
4	FG101123	Flow Plate, (FOBA # 032510)
5	CCEFOBA100L	Ceramic Cavity, Lower, (FOBA # 034100)
6	LL5113	Laser Lamp, Krypton (FOBA # 05110)
7	YR4117	YAG Rod, 4 mm (FOBA # 021010)
8	RBTFOBA100)	Rod Beam Tube, (FOBA # M33010)
9	RPPFOBA100	YAG Rod Pressure Plate (FOBA # 03410)
10	LHBFOBA100	Lower Head Block (FOBA # M31030)
11	WF075	Water Fitting, Q switch

FREQUENTLY USED CONSUMABLES:

REFERENCE	ITEM	PART NUMBER
1	Lamp	LL5113
2	Flow Plate	FG101123
3	O-Ring Kit	ORKFOBA100
4	D.I. Resin	DIRE SIN100
5	Particle Filter	PF75
6	Front Mirror 75%R	MR3M75RHC
7	Rear Mirror HR	MR3M100RHC

Other consumables upon request.

LAMP PUMPED LASER HEADS

High performance and reliability

Part No: CHBAFOBA100

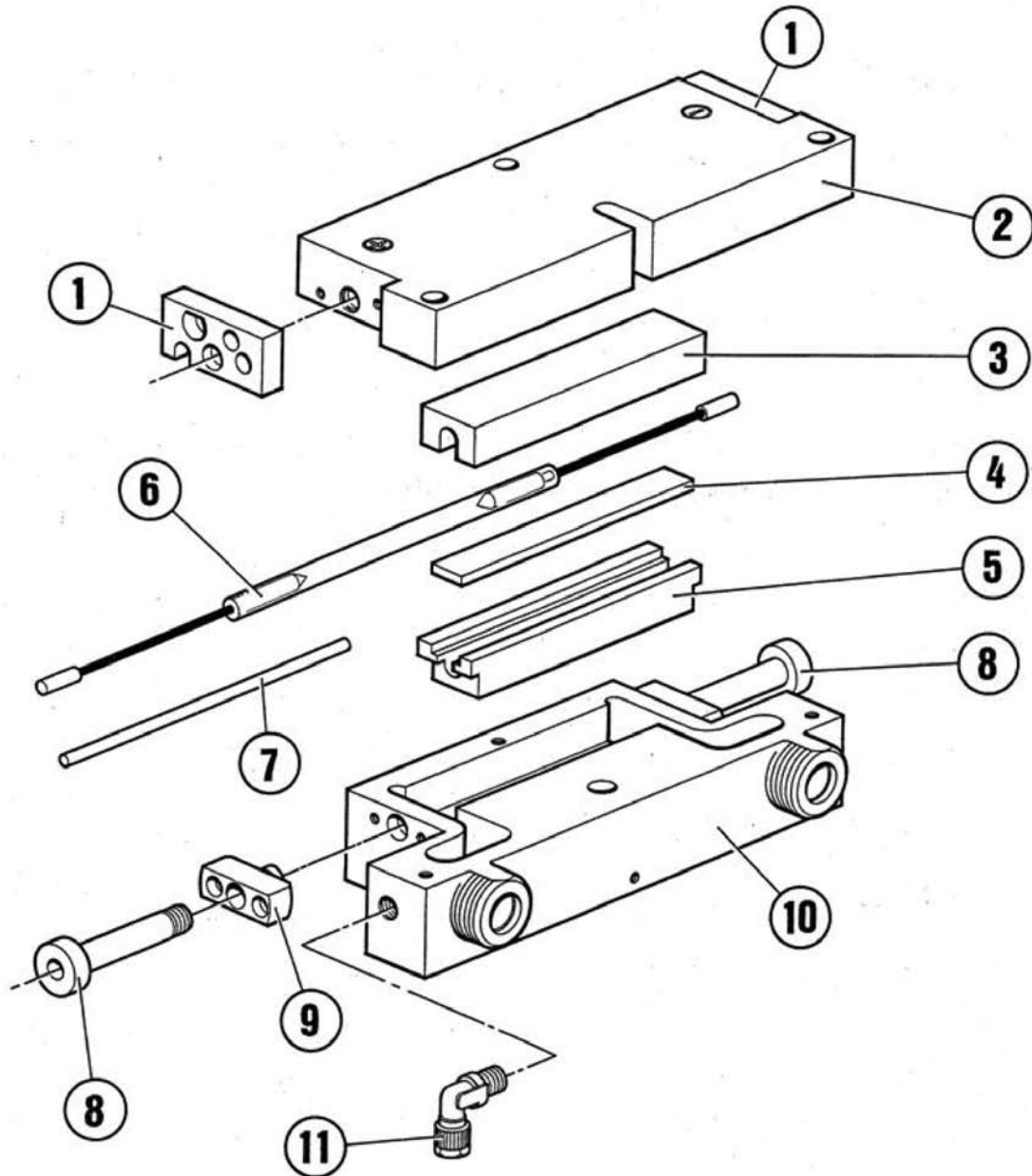

Intelligent Solutions, Manufacturing & Development